

CENTRAL PORT COVER
(Available Color Coded)

FL76/CD COVER

FL76 FRAME

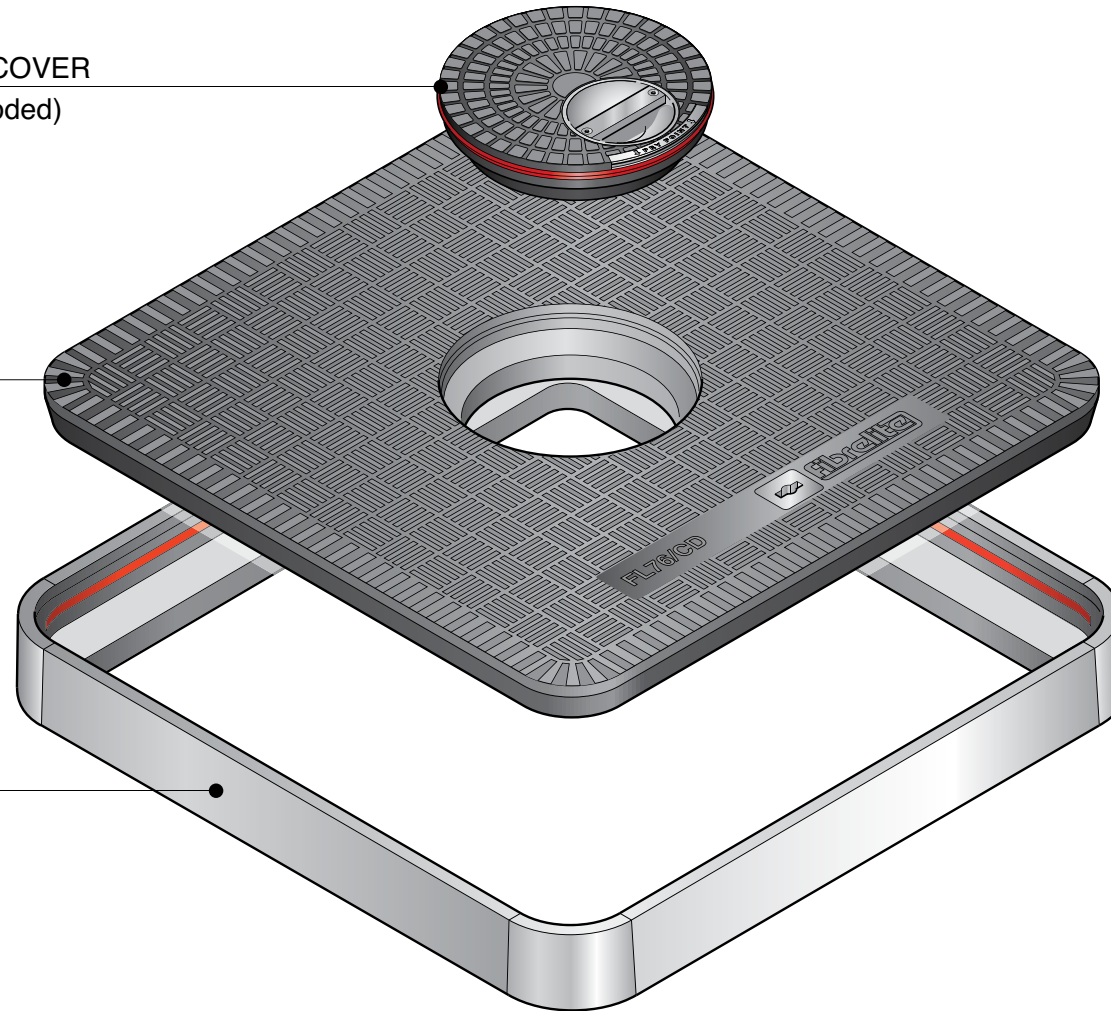

30" x 30" flat sealed composite cover with a sealed centre dip cap and aluminum frame.

For reference purposes only. This drawing is not a specification. Order against product code only. To enable continuous improvement of our products, the designs and specifications are subject to change without notice.

FIBRELITE 
PART OF OPW A DOVER COMPANY

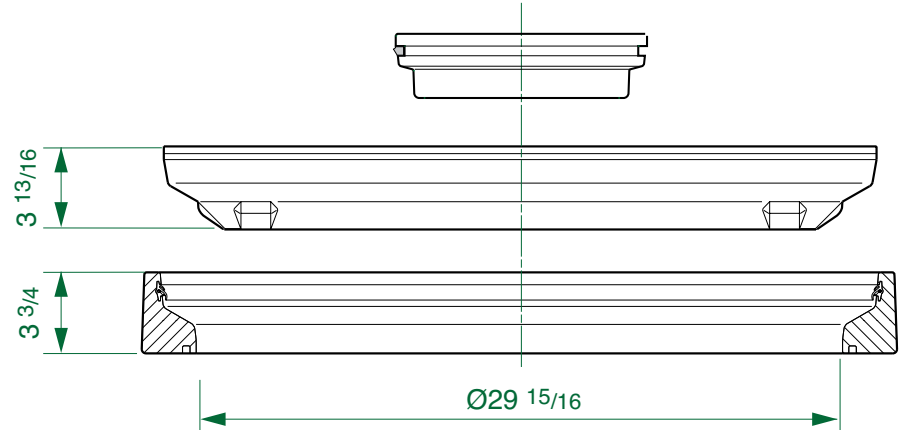
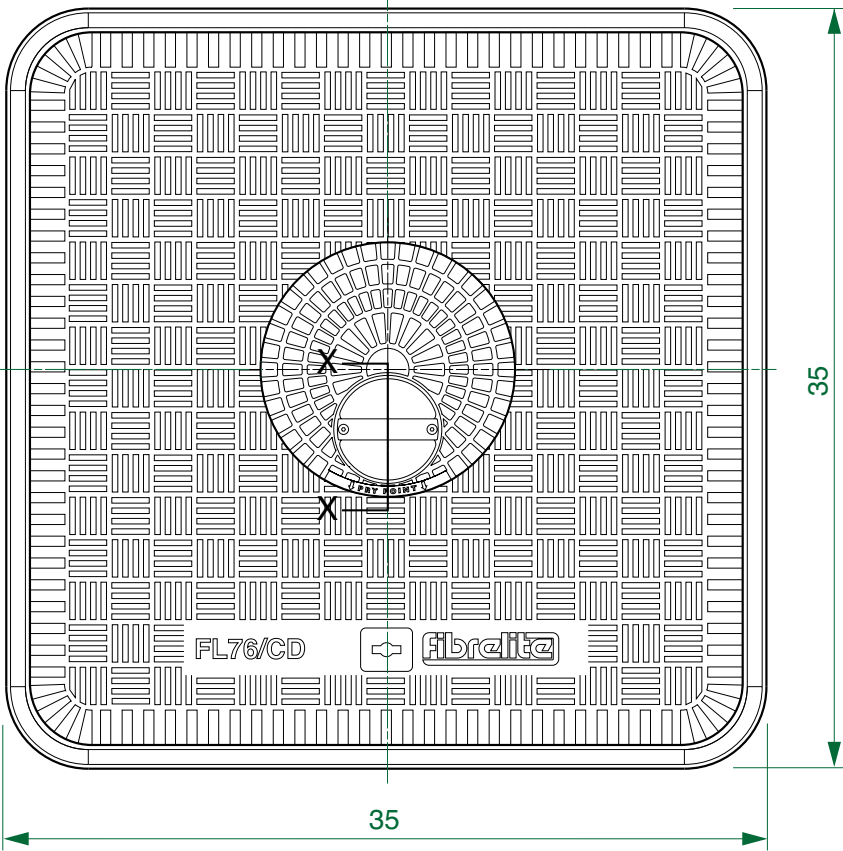
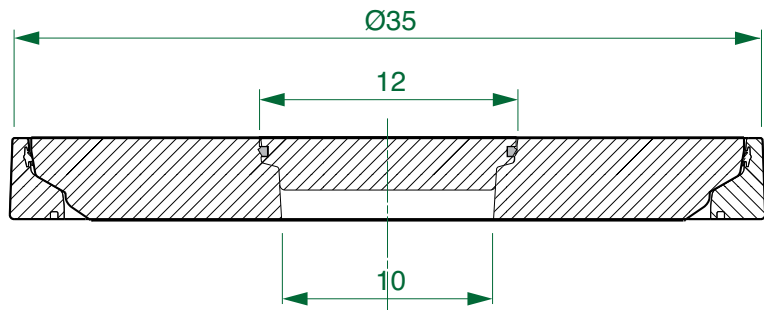

Load Rating	Cover Weight	Frame Weight
H20	63.9 lbs	26.4 lbs
H25	90.4 lbs	26.4 lbs

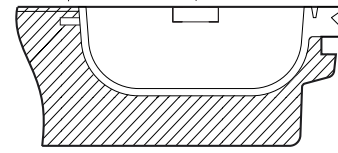

SECTION X - X
HANDLE BOWL

30" x 30" flat sealed composite cover with a sealed centre dip cap and aluminum frame.

For reference purposes only. This drawing is not a specification. Order against product code only. To enable continuous improvement of our products, the designs and specifications are subject to change without notice.



CONCRETE

VERY IMPORTANT

OUTER EDGE "A" OF FRAME SET 1/4 ABOVE GENERAL FORECOURT AREA WITH CONCRETE RAMPED AWAY OVER 12"

VERY IMPORTANT

The underside of the frame must be adequately supported by concrete.

Expansion joint filled with petrol resistant mastics.

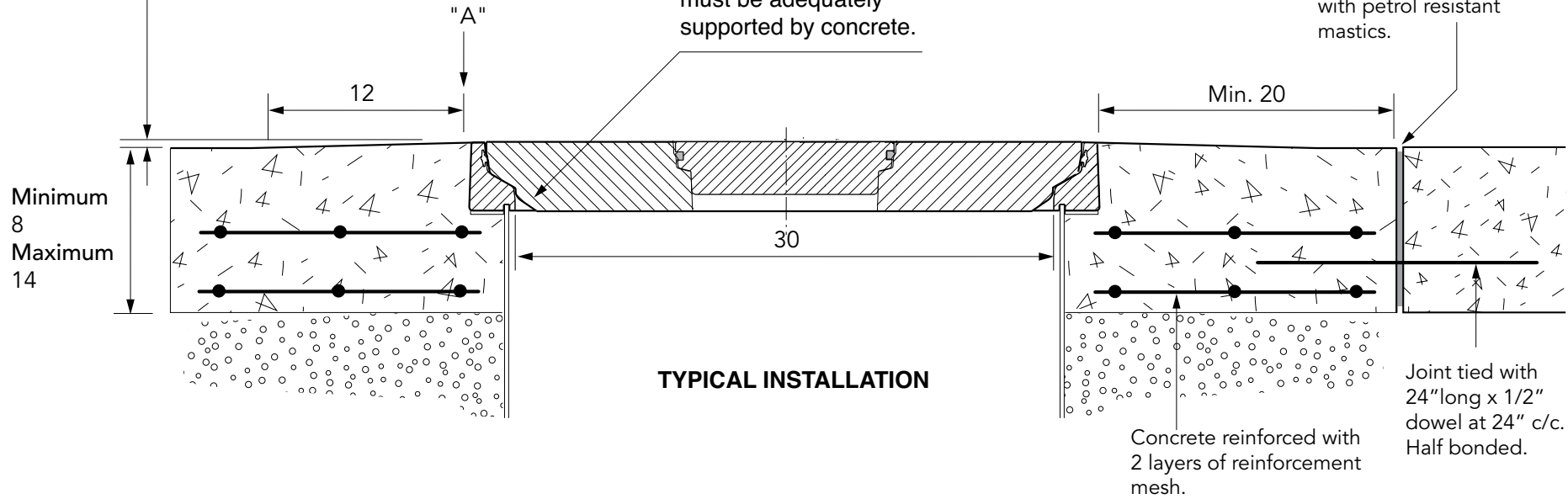

TARMACADAM

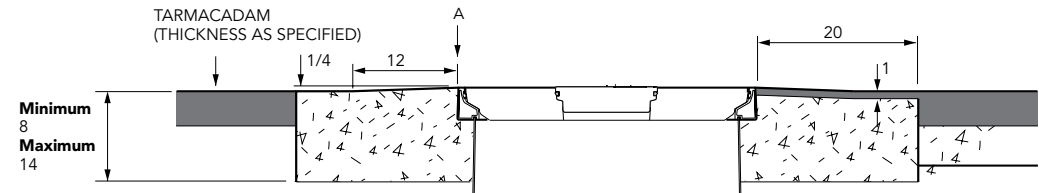

30" x 30" flat sealed composite cover with a sealed centre dip cap and aluminum frame.

For reference purposes only. This drawing is not a specification. Order against product code only. To enable continuous improvement of our products, the designs and specifications are subject to change without notice.

