

24" x 24" raised composite cover with an aluminium frame.

For reference purposes only. This drawing is not a specification. Order against product code only. To enable continuous improvement of our products, the designs and specifications are subject to change without notice.

FIBRELITE 
PART OF OPW A  DOVER COMPANY

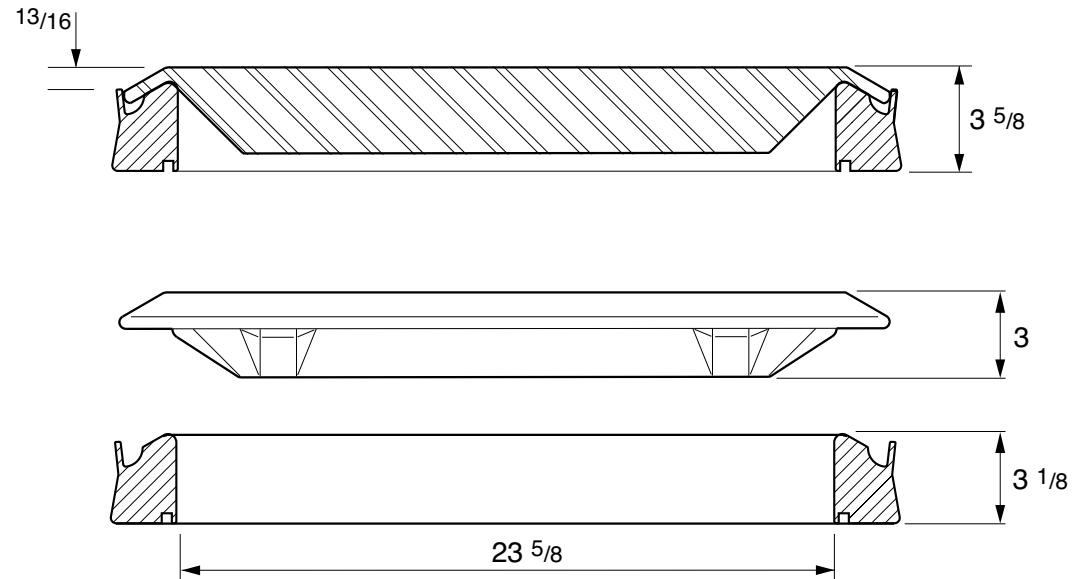
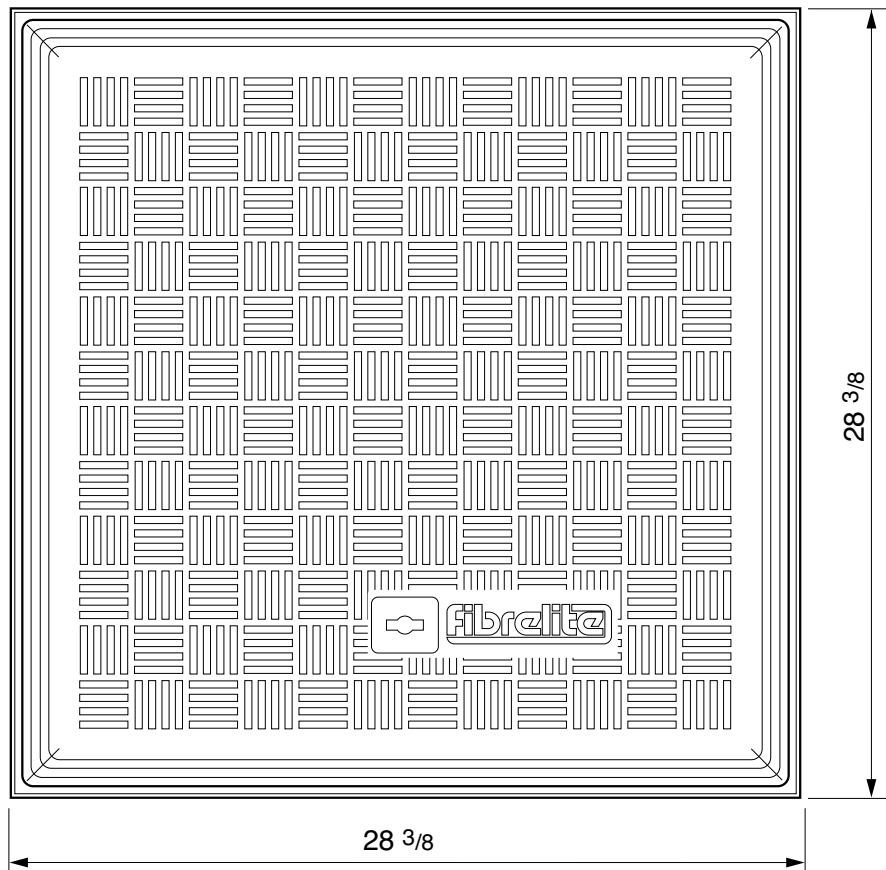

Load Rating	Cover Weight	Frame Weight
SD	41.8 lbs	17.6 lbs

24" x 24" raised composite cover with an aluminium frame.

For reference purposes only. This drawing is not a specification. Order against product code only. To enable continuous improvement of our products, the designs and specifications are subject to change without notice.



CONCRETE

VERY IMPORTANT

OUTER EDGE "A" OF FRAME SET 1/4" - 1/2" ABOVE GENERAL GRADE AREA WITH CONCRETE RAMPED AWAY OVER 12"

VERY IMPORTANT
The underside of the frame must be adequately supported by concrete.

Expansion joint filled with petrol resistant mastic.

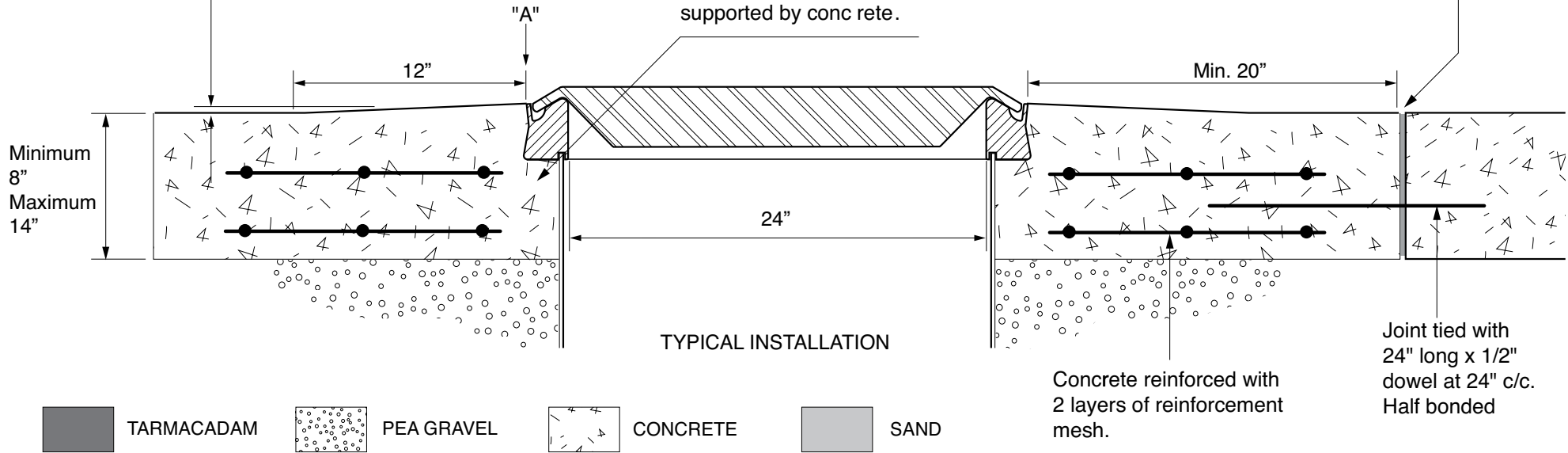

TARMACADAM

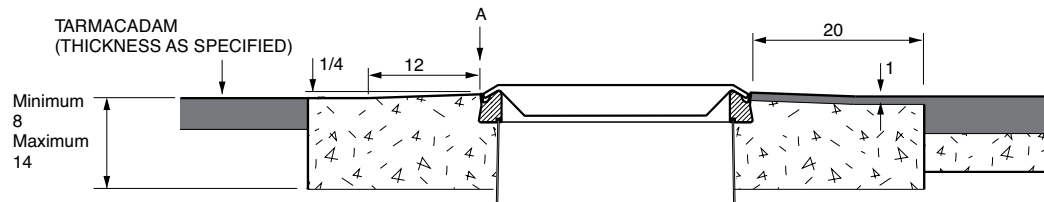

24" x 24" raised composite cover with an aluminium frame.

For reference purposes only. This drawing is not a specification. Order against product code only. To enable continuous improvement of our products, the designs and specifications are subject to change without notice.

